

# ER500-2800

**EFORT**

**ER500-2800,**  
Maxium payload 500 kg with maxium reach 2813 mm.

## Highlights

The all-new heavy-duty platform product adopts fully rigid gear connections on all axes, offering exceptional robot wrist torque performance; With a 50% improvement in repeat positioning accuracy—ranking among the best in its class—the robot is well-suited for a wide range of high-precision applications;

By integrating a high-stiffness transmission design with advanced trajectory algorithms, it achieves stronger dynamic performance and maintains stable operation at high speeds.

## Applications

It can be used in applications including machining, material handling, friction welding, and more.

## Industries

Suitable for industries such as metal, automotive, lithium battery, and aerospace.



## SPECIFICATIONS

<b>Model</b>	ER580-2800	
<b>Type</b>	Articulated	
<b>Controlled axes</b>	6 Axes	
<b>Max. payload on wrist</b>	500 kg	
<b>Repeatability</b>	±0.1 mm	
<b>Robot weight</b>	2495 kg	
<b>Reach</b>	2813 mm	
<b>Robot IP grade</b>	IP65 / IP67 (Wrist)	
<b>Cabinet IP grade</b>	IP54	
<b>Drive mode</b>	AC servo drive	
<b>Installation</b>	Floor	
<b>Installation enviroment</b>	<b>Ambient temperature</b>	0~45 °C
	<b>Ambient humidity</b>	RH≤80% (No dew nor frost allowed)
	<b>Vibration acceleration</b>	4.9 m/s <sup>2</sup> (<0.5 G)

<b>Allowable load moment at wrist</b>	<b>J4</b>	3020 N·m
	<b>J5</b>	3020 N·m
	<b>J6</b>	1560 N·m
<b>Allowable load inertia at wrist</b>	<b>J4</b>	500 kg·m <sup>2</sup>
	<b>J5</b>	500 kg·m <sup>2</sup>
	<b>J6</b>	315 kg·m <sup>2</sup>
<b>Maximum speed</b>	<b>J1</b>	90°/sec
	<b>J2</b>	100°/sec
	<b>J3</b>	100°/sec
	<b>J4</b>	100°/sec
	<b>J5</b>	100°/sec
	<b>J6</b>	160°/sec
<b>Motion range</b>	<b>J1</b>	±185°
	<b>J2</b>	+65°-85°
	<b>J3</b>	+27°-130°
	<b>J4</b>	±360°
	<b>J5</b>	±130°
	<b>J6</b>	±360°

## OPERATING SPACE

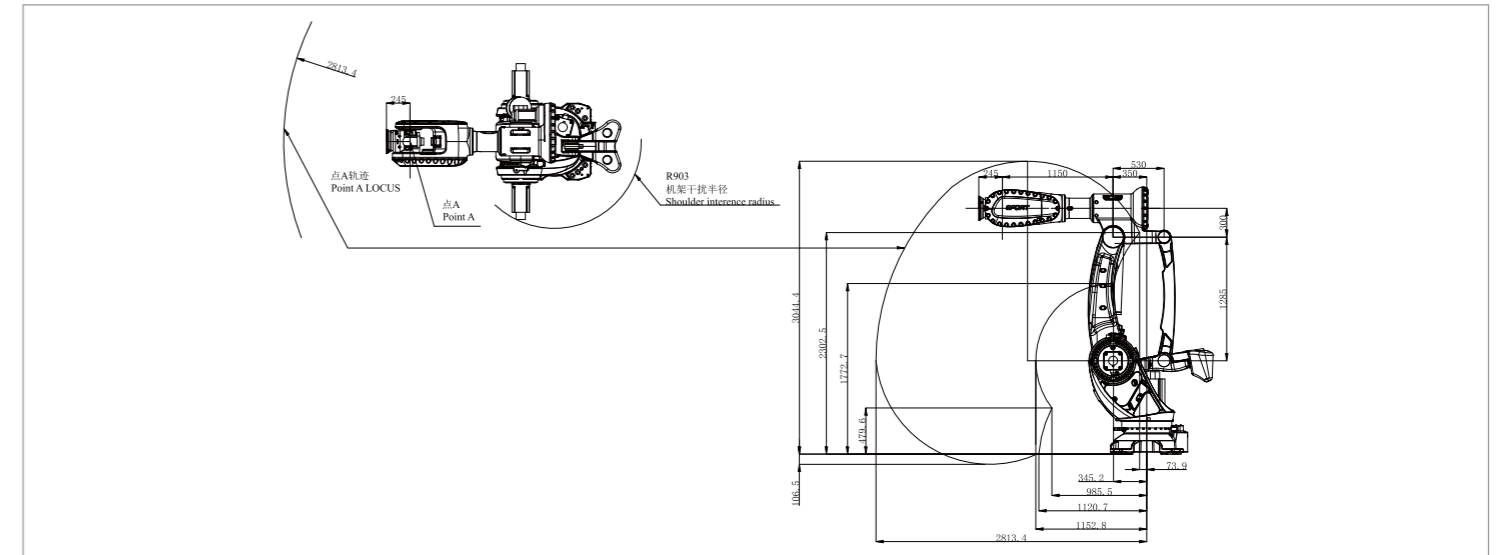

## BASE MOUNTING SIZE

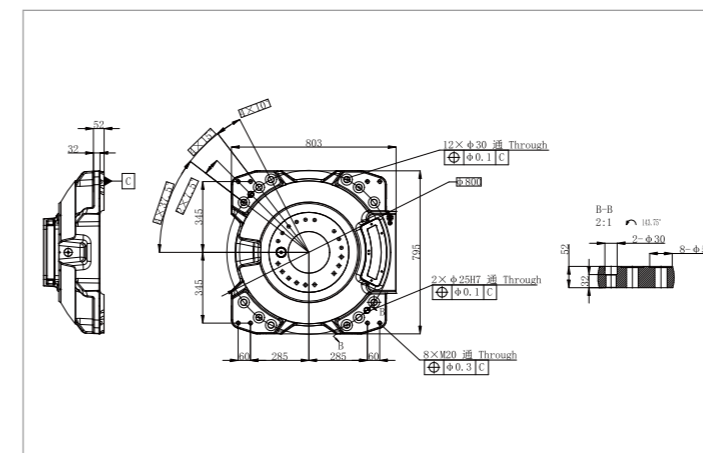

## END FLANGE MOUNTING SIZE

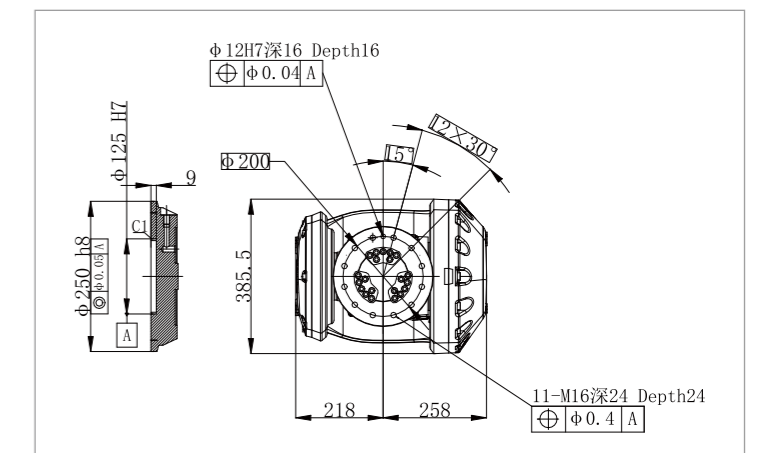

**EFORT Intelligent Robot Co., Ltd.**  
PHONE: (00 86) 400-052-8877  
ADDRESS: No. 96, Wanchun East Road, Wuhu, China  
(Anhui) Pilot Free Trade Zone  
WWW.EFORT.COM.CN

\*The final interpretation right belongs to EFORT Intelligent Robot Co., Ltd. Any updates will be made without prior notice.