

ER360-3300

EFORT

ER360-3300,
Maxium payload 360 kg with maxium reach 3288 mm.

Highlights

The all-new heavy-duty platform product adopts fully rigid gear connections on all axes, offering exceptional robot wrist torque performance; With a 50% improvement in repeat positioning accuracy—ranking among the best in its class—the robot is well-suited for a wide range of high-precision applications;

By integrating a high-stiffness transmission design with advanced trajectory algorithms, it achieves stronger dynamic performance and maintains stable operation at high speeds.

Applications

It can be used in applications including machining, material handling, friction welding, and more.

Industries

Suitable for industries such as metal, automotive, lithium battery, and aerospace.

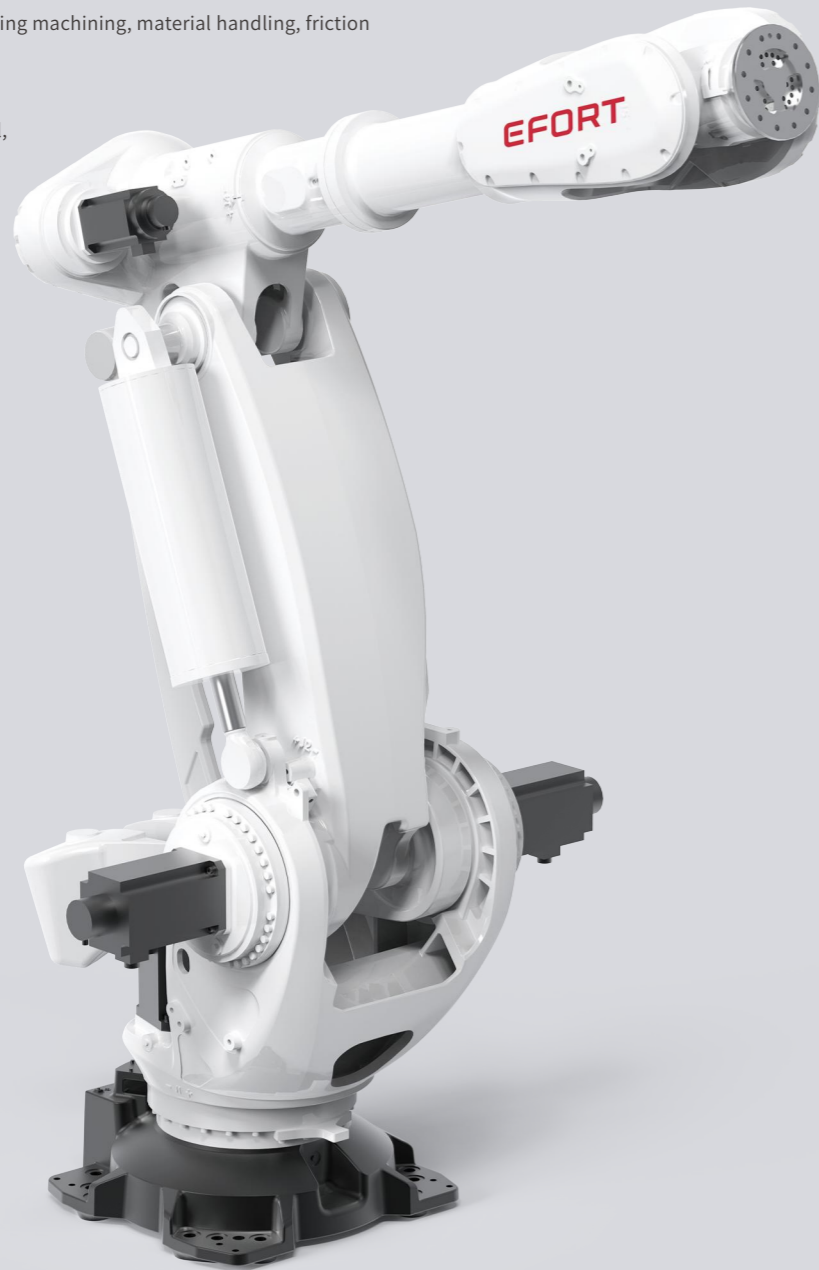

SPECIFICATIONS

Model	ER360-3300	
Type	Articulated	
Controlled axes	6 Axes	
Max. payload on wrist	360 kg	
Repeatability	±0.1 mm	
Robot weight	2530 kg	
Reach	3288 mm	
Robot IP grade	IP65 / IP67 (Wrist)	
Cabinet IP grade	IP54	
Drive mode	AC servo drive	
Installation	Floor	
Installation enviroment	Ambient temperature	0~45 °C
	Ambient humidity	RH≤80% (No dew nor frost allowed)
	Vibration acceleration	4.9 m/s ² (<0.5 G)

Allowable load moment at wrist	J4	3020 N·m
	J5	3020 N·m
	J6	1560 N·m
Allowable load inertia at wrist	J4	500 kg·m ²
	J5	500 kg·m ²
	J6	315 kg·m ²
Maximum speed	J1	90°/sec
	J2	100°/sec
	J3	100°/sec
	J4	100°/sec
	J5	100°/sec
	J6	160°/sec
Motion range	J1	±185°
	J2	+65°-85°
	J3	+27°-130°
	J4	±360°
	J5	±130°
	J6	±360°

OPERATING SPACE

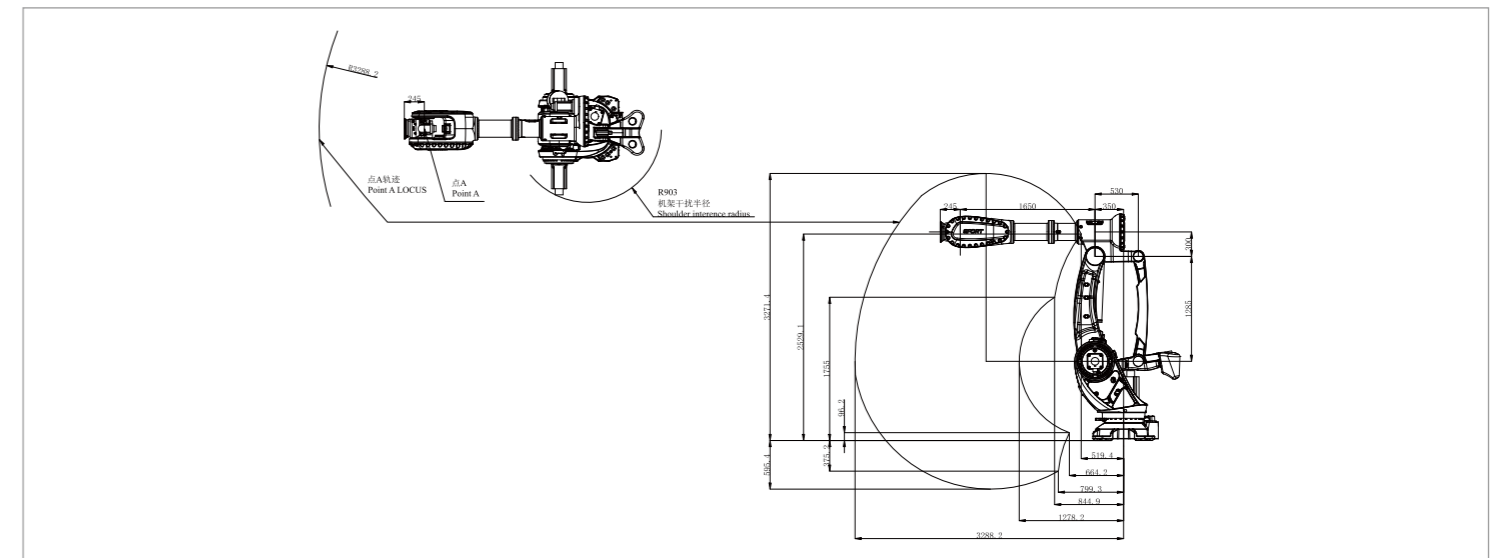

BASE MOUNTING SIZE

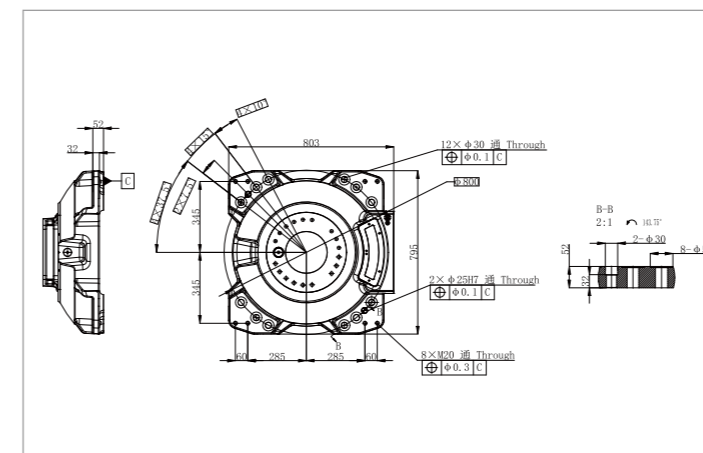

END FLANGE MOUNTING SIZE

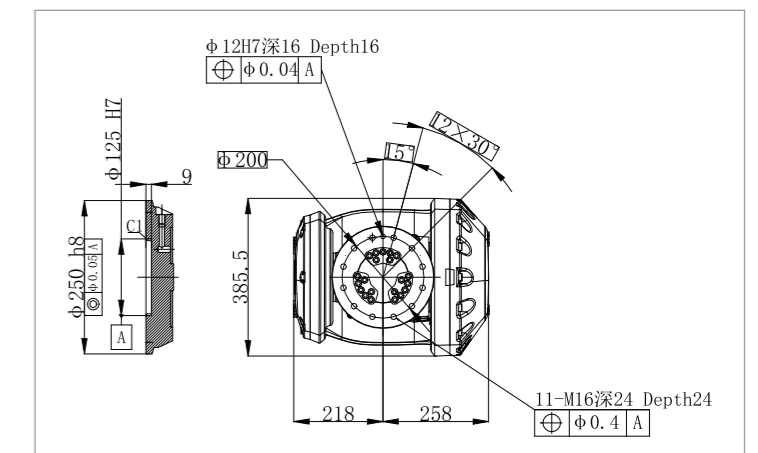

EFORT Intelligent Robot Co., Ltd.
PHONE: (00 86) 400-052-8877
ADDRESS: No. 96, Wanchun East Road, Wuhu, China
(Anhui) Pilot Free Trade Zone
WWW.EFORT.COM.CN

*The final interpretation right belongs to EFORT Intelligent Robot Co., Ltd. Any updates will be made without prior notice.